

NOTES:
 1. LOCATIONS OF UNDERGROUND UTILITIES WERE OBTAINED FROM EXISTING MAPS AND MS 811 REQUEST NO. 24030408900438.
 2. ELEVATIONS ARE REFERENCED TO N.A.V.D. 88 BY OBSERVED G.N.S.S. SOLUTION.
 3. THE PROPERTY IS LOCATED WITHIN AN AREA HAVING A ZONE DESIGNATION "A" BY THE FEDERAL EMERGENCY MANAGEMENT AGENCY (FEMA), ON FLOOD INSURANCE RATE MAP NO. 28150C0102C, WITH A DATE OF IDENTIFICATION OF JANUARY 06, 2010, IN THE CITY OF EUPORA, STATE OF MISSISSIPPI, WHICH IS THE CURRENT FLOOD INSURANCE RATE MAP FOR THE COMMUNITY IN WHICH THE PROPERTY IS SITUATED.
 4. CREEP FIBER IS LOCATED ON THE NORTH SIDE OF HALL ROAD & THE EAST SIDE OF HIGHWAY 9.
 5. WATER ELEVATION OF WHITES CREEK WAS 370.40 FEET, DATE OF 03/07/2024.
 6. BOUNDARY PERFORMED BY TD SURVEYING, LLC.

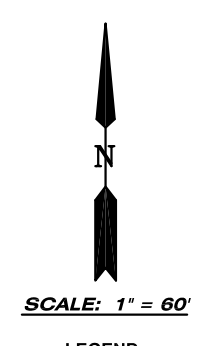

- LEGEND
- ▲ CONTROL POINT
 - PP POWER POLE
 - AREA LIGHT
 - SPICOT
 - AT&T TELEPHONE PEDESTAL
 - CREPE MYRTLE
 - GRATE INLET
 - SPEED BUMP
 - + 124.5 SPOT ELEVATION
 - CYCLONE FENCE
 - BOUNDARY LINE
 - DITCH W/ FLOW ARROW
 - P OVERHEAD POWER LINE

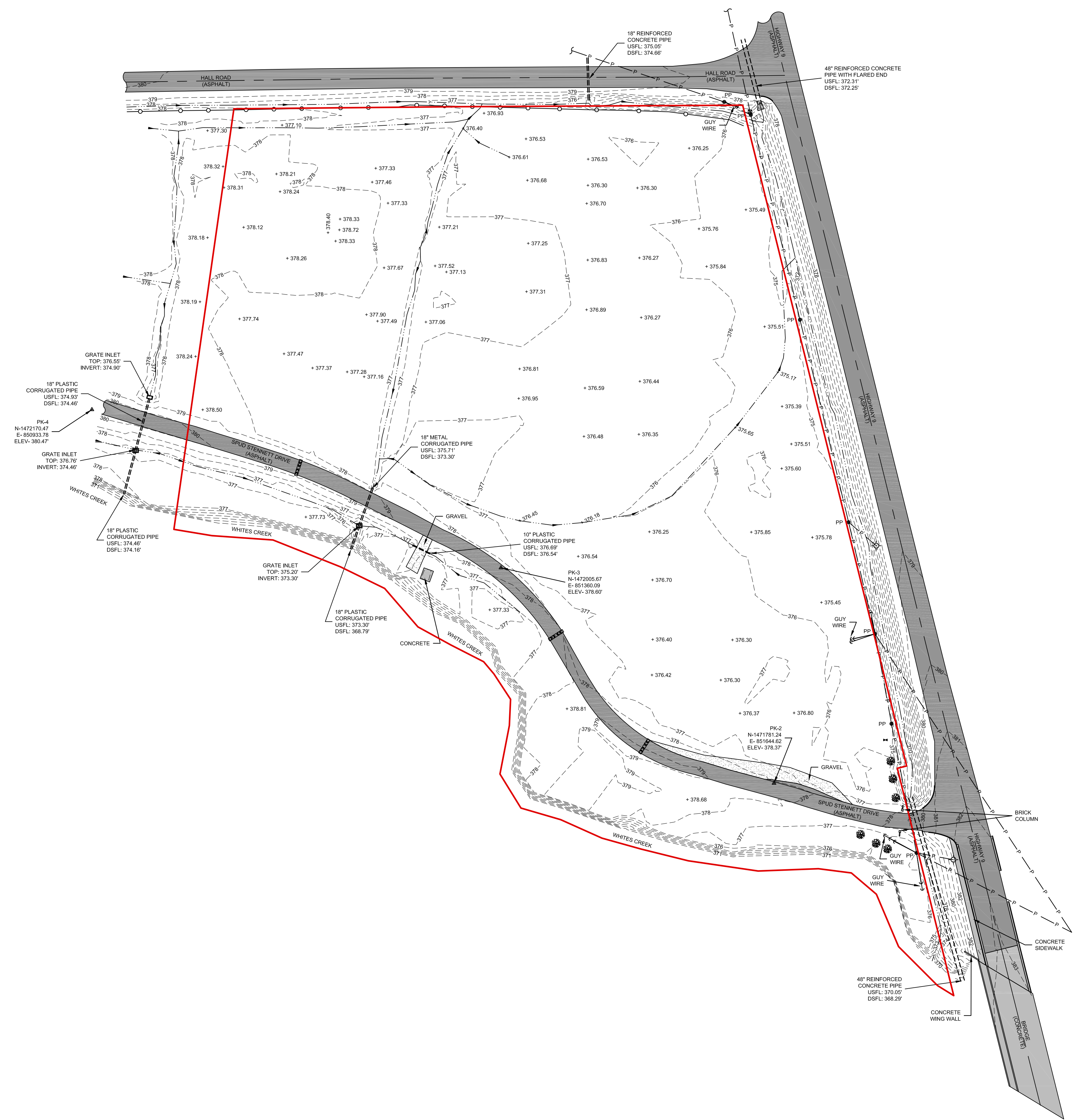

DREW MORGAN
 LICENSED PROFESSIONAL SURVEYOR
 PS-22710
 Drew Morgan, PLS
 Mississippi Professional Land Surveyor #32710

Date 03/13/2024

TOPOGRAPHIC SURVEY SPUD STENNETT PARK EUPORA, MISSISSIPPI		
FOR CITY OF EUPORA		
DRAWN BY: DM	DATE: 03/07/2024	SHEET 1
CHECKED BY: DM	SCALE: 1" = 60'	OF 1
PROJECT NO.: 24-S-21	REVISION #:	

DREW MORGAN
 2656 CRAIG SPRINGS RD.
 STURGIS, MISSISSIPPI 39769
 662-769-7586
 LAND SURVEYING & MAPPING